

# High-Speed POLAR N

the program  
with a capacitive 18.5"

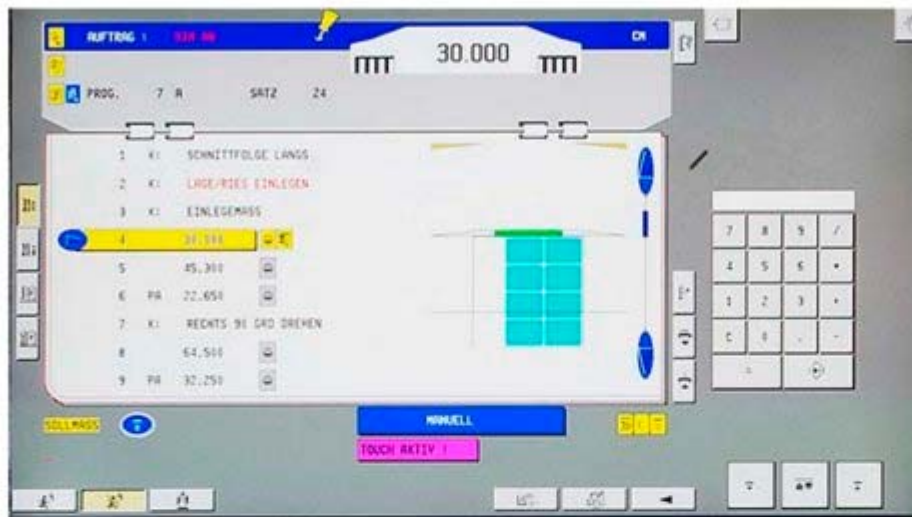

## Description of POLAR N 115 PLUS

The allrounder with 18.5" color display and touch-screen operation is suitable for all standard cutting jobs. Featuring automatic graphic programming it ensures a highly-automated process.

Examples of equipment:

- ▄ Highly graphic operator guidance, with various language packages
- ▄ Change-over measurement system (metric, inch, shaku)
- ▄ Configurable user interface, OptiKnife knife changing system and many other features

The High-Speed Cutter POLAR N 115 is mainly used in the medium-size range. Formats up to a diagonal of 1,150 mm can be easily handled and turned in the high-speed cutter. Cutting material with larger formats can only be turned on the front table. The High-Speed Cutter has extensive features in the standard equipment already which can increase the productivity up to 20%. The High-Speed Cutter can be upgraded with

- ▄ Greatest cutting accuracy due to Positioning-System DPS with a maximum positioning accuracy of 1/100 mm
- ▄ Highly reliable in daily use and long service life as a result of the stability of the one-piece frame, knife drive with worm gear and closed hydraulic system

## Technical data

Cutting width	
Feeding depth	
Loading height max.	
Safety clamp pressure	
Clamp pressure, min	
Clamp pressure, max.	4
Backgauge speed on return way (0 - ...)	

peripheral equipment (HIT, jogger, buffer, transport grippers, loading and unloading system) to a cutting system.

## Customer benefits

- Extended operating life of the knife as well as faster knife change thanks to POLAR OptiKnife with knife fine adjustment in the lower dead end
- High productivity by a great number of programmable additional functions
- Shortest make ready times thanks to intuitive cutting program generation via block programming or even Compucut

POLAR-Mohr Maschinenvertriebsgesellschaft GmbH & Co. KG  
Hattersheimer Straße 16 - 42 \ 65719 Hofheim \ Germany  
info@polar-mohr.com \ www.polar-mohr.com

knife speed	
Smallest cut, automatically, without false plate	
Smallest cut, automatically, with false plate	

Further technical data are available for download



# High-Speed POLAR N 115

the programmable high-speed cutter  
with a capacitive 21.5"



## Description of POLAR N 115 PRO HD

The programmable high performance model with a capacitive 21.5" Touch-Screen display and real image preview is ideal for high-end applications - thanks to job specific programmable parameter, label and distortion correction as well as an extended range of options.

The High-Speed Cutter POLAR N 115 is mainly used in the medium-size range. Formats up to a diagonal of 1,150 mm can be easily handled and turned in the high-speed cutter. Cutting material with larger formats can only be turned on the front table. The High-Speed Cutter has extensive features in the standard equipment already which can increase the productivity up to 20%. The High-Speed Cutter can be upgraded with peripheral equipment (lift, jogger, buffer, transport grippers, loading and unloading system) to a cutting system.

## Customer benefits

- // Extended operating life of the knife as well as faster knife change thanks to POLAR OptiKnife with knife fine adjustment in the lower dead end
- // High productivity by a great number of

## Technical data

Cutting width	
Feeding depth	
Loading height max.	
Safety clamp pressure	
Clamp pressure, min	
Clamp pressure, max.	
Backgauge speed on return way (0 - ...)	
Knife speed	
Smallest cut, automatically,	

- programmable additional functions
- // Shortest make ready times thanks to intuitive cutting program generation via block programming or even Compucut
- // Greatest cutting accuracy due to the POLAR-Positioning-System DPS with a mechanical positioning accuracy of 1/100 mm
- // Highly reliable in daily use and long lifespan as a result of the stability of the one-piece machine frame, knife drive with worm gear drive and compact closed hydraulic system

without false plate	
Smallest cut, automatically, with false plate	

Further technical data are available for download

POLAR-Mohr Maschinenvertriebsgesellschaft GmbH & Co. KG  
 Hattersheimer Straße 16 - 42 \ 65719 Hofheim \ Germany  
 info@polar-mohr.com \ www.polar-mohr.com



# High-Speed POLAR N

with automatic  
a capacitive 21.



## Description of POLAR N 115 AT HD

Model N 115 AT HD is the most-efficient of this type of high-speed cutter, featuring automatic waste disposal during the cutting process.

## Technical data

Cutting width	
---------------	--

The High-Speed Cutter POLAR N 115 is mainly used in the medium-size range. Formats up to a diagonal of 1,150 mm can be easily handled and turned in the high-speed cutter. Cutting material with larger formats can only be turned on the front table. The High-Speed Cutter has extensive features in the standard equipment already which can increase the productivity up to 20%. The High-Speed Cutter can be upgraded with peripheral equipment (lift, jogger, buffer, transport grippers, loading and unloading system) to a cutting system.

### Customer benefits

- // Extended operating life of the knife as well as faster knife change thanks to POLAR OptiKnife with knife fine adjustment in the lower dead end
- // High productivity by a great number of programmable additional functions
- // Shortest make ready times thanks to intuitive cutting program generation via block programming or even Compucut
- // Greatest cutting accuracy due to the POLAR-Positioning-System DPS with a mechanical positioning accuracy of 1/100 mm
- // Highly reliable in daily use and long lifespan as a result of the stability of the one-piece machine frame, knife drive with worm gear drive and compact closed hydraulic system

Feeding depth	
Loading height max.	
Safety clamp pressure	
Clamp pressure, min	
Clamp pressure, max.	
Backgauge speed on return way (0 - ...)	
Knife speed	
Smallest cut, automatically, without false plate	
Smallest cut, automatically, with false plate	

Further technical data are available for download

POLAR-Mohr Maschinenvertriebsgesellschaft GmbH & Co. KG  
 Hattersheimer Straße 16 – 42 \ 65719 Hofheim \ Germany  
 info@polar-mohr.com \ www.polar-mohr.com



# High-Speed POLAR N 115

the programmable high-speed cutter  
with a capacitive 21.5"



## Description of POLAR N 115 PRO HD

The programmable high performance model with a capacitive 21.5" Touch-Screen display and real image preview is ideal for high-end applications - thanks to job specific programmable parameter, label and distortion correction as well as an extended range of options.

The High-Speed Cutter POLAR N 115 is mainly used in the medium-size range. Formats up to a diagonal of 1,150 mm can be easily handled and turned in the high-speed cutter. Cutting material with larger formats can only be turned on the front table. The High-Speed Cutter has extensive features in the standard equipment already which can increase the productivity up to 20%. The High-Speed Cutter can be upgraded with peripheral equipment (lift, jogger, buffer, transport grippers, loading and unloading system) to a cutting system.

## Customer benefits

- // Extended operating life of the knife as well as faster knife change thanks to POLAR OptiKnife with knife fine adjustment in the lower dead end
- // High productivity by a great number of

## Technical data

Cutting width	
Feeding depth	
Loading height max.	
Safety clamp pressure	
Clamp pressure, min	
Clamp pressure, max.	
Backgauge speed on return way (0 - ...)	
Knife speed	
Smallest cut, automatically,	



The High-Speed Cutter POLAR N 115 is mainly used in the medium-size range. Formats up to a diagonal of 1,150 mm can be easily handled and turned in the high-speed cutter. Cutting material with larger formats can only be turned on the front table. The High-Speed Cutter has extensive features in the standard equipment already which can increase the productivity up to 20%. The High-Speed Cutter can be upgraded with peripheral equipment (lift, jogger, buffer, transport grippers, loading and unloading system) to a cutting system.

### Customer benefits

- // Extended operating life of the knife as well as faster knife change thanks to POLAR OptiKnife with knife fine adjustment in the lower dead end
- // High productivity by a great number of programmable additional functions
- // Shortest make ready times thanks to intuitive cutting program generation via block programming or even Compucut
- // Greatest cutting accuracy due to the POLAR-Positioning-System DPS with a mechanical positioning accuracy of 1/100 mm
- // Highly reliable in daily use and long lifespan as a result of the stability of the one-piece machine frame, knife drive with worm gear drive and compact closed hydraulic system

Feeding depth	
Loading height max.	
Safety clamp pressure	
Clamp pressure, min	
Clamp pressure, max.	
Backgauge speed on return way (0 - ...)	
Knife speed	
Smallest cut, automatically, without false plate	
Smallest cut, automatically, with false plate	

Further technical data are available for download

POLAR-Mohr Maschinenvertriebsgesellschaft GmbH & Co. KG  
 Hattersheimer Straße 16 – 42 \ 65719 Hofheim \ Germany  
 info@polar-mohr.com \ www.polar-mohr.com







Ersatzteile

POLAR 115 E  
115 ED

Spare Parts  
Pièces détachées  
Piezas de repuesto  
Pezzi di ricambio

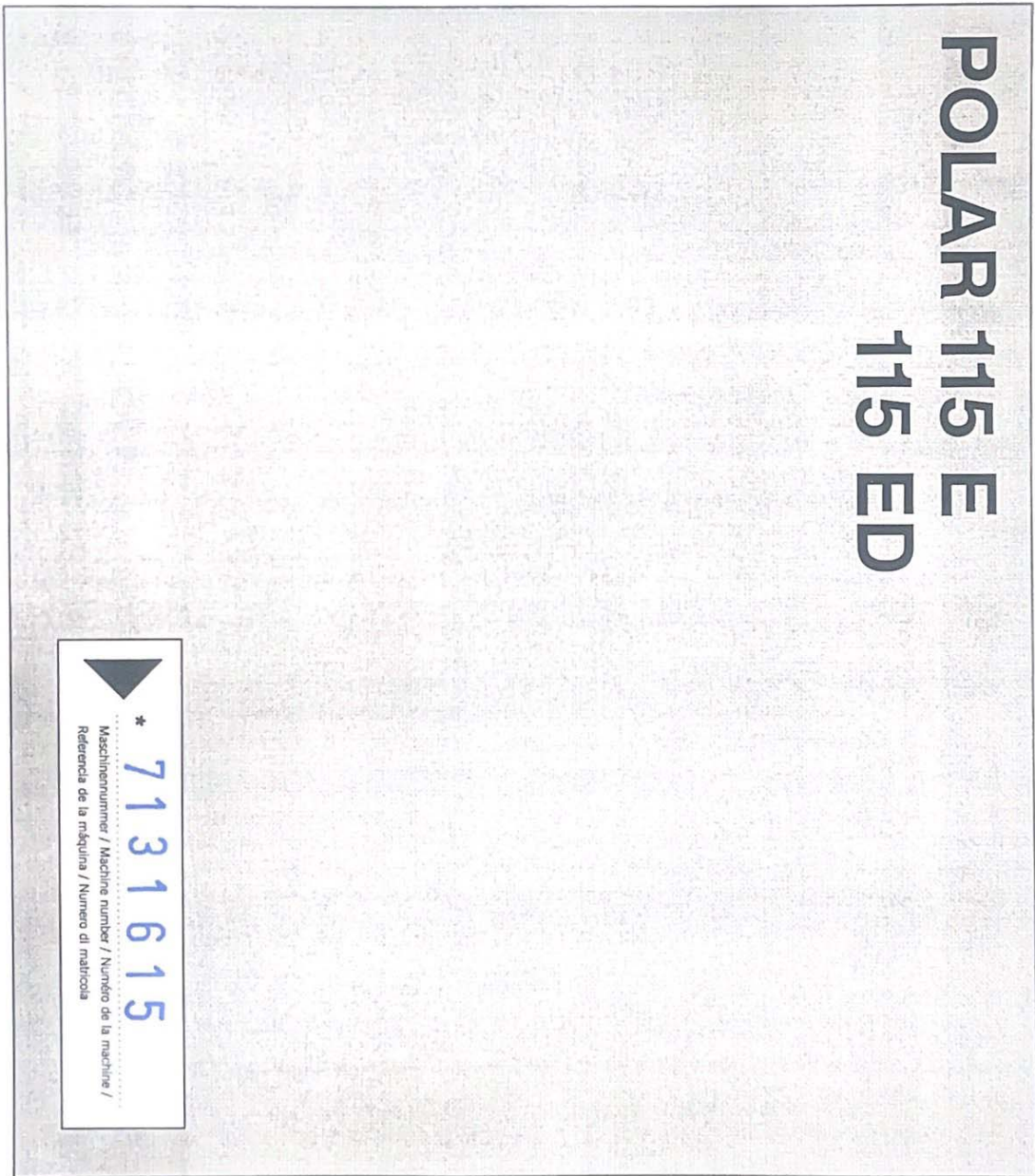

▼  
\* 7131615  
.....  
Maschinennummer / Machine number / Numéro de la machine /  
Referencia de la máquina / Numero di matricola

Z115X-00.00.1A-01

\*Achtung! Sonderausführungen  
\*Attention! Special equipment

1

115 E - 10.00.

gültig ab Masch.-Nr.: 7031001  
valid from mach.-no.:  
gültig bis Masch.-Nr.: .....  
to mach.-no.: .....

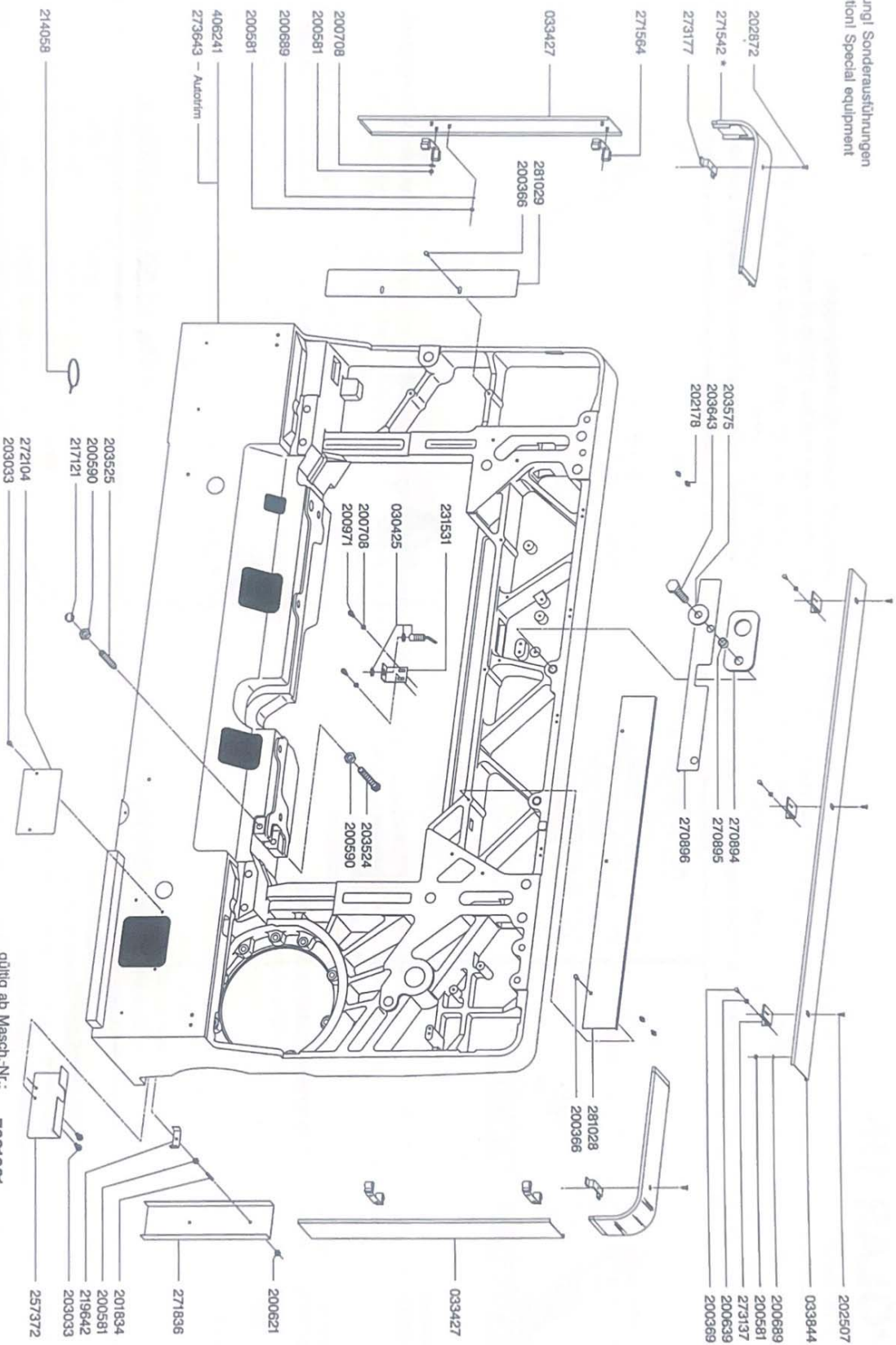

Z115E-10.00.1A-01

\*Achtung! Sonderausführungen  
\*Attention! Special equipment

ZH15E-10.01.1A-03

( 042793 ) a

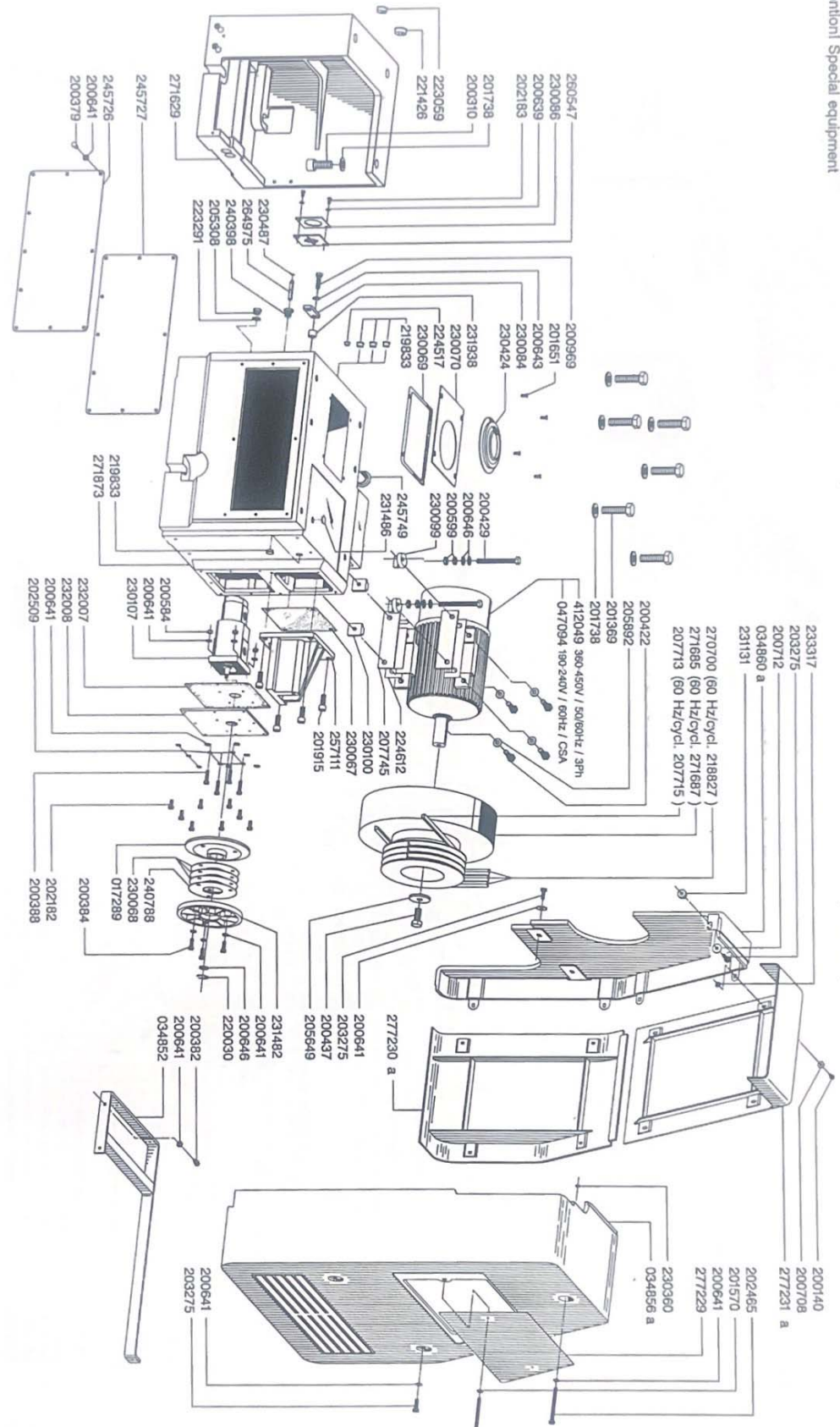

3

115 E - 10.01.

gültig ab Masch.-Nr.: 7131601  
valid from mach.-no.:  
gültig bis Masch.-Nr.: .....  
to mach.-no.: .....