



SEYHAN AMBALAJ MACHINERY CO.

Turkish Manufacturer, based in BOĞAZKÖY- NEVSEHIR, SEYHAN AMBALAJ designs since 1992 solutions for automatic packaging machines of food, biscuits, detergent, pharmaceuticals, dry chemical, powder and other dry products, today he is one of leaders its sector in Turkey.

With an experience of nearly 30 years and a team of experts in packaging techniques, SEYHAN offers a varied collection of advanced packaging equipment and products designed and manufactured on site and other packaging services.

Whether machines in its range of standard or custom up to your products and production capacity, our first objective is to satisfy you.

The sales team, technicians of the design office and workshop, accompany you in the implementation of your new projects, from design to start-up on your site.

Our packaging machines are designed for packing a wide variety of products; it's built with high quality materials and takes into account measures such as ergonomics, ease of maintenance, simplicity in operation and absolute hygiene achieved with smooth surfaces or rounded edges.

After-sales services are provided by SEYHAN's teams.



ADRESS: KIŞLA CAD. TOPÇULAR OTO SAN. SİTESİ NO:114 TOPÇULAR/İSTANBUL/TÜRKİYE

Tel: 0212 501 47 70 www.seyhanambalaj.com



[/seyhanambalajmakina](https://www.linkedin.com/company/seyhanambalajmakina)



GOLD – PACKING MACHINE BY 4 HEADS WEIGHER



4 pneumatic heads weigher packaging machine can be used for packaging various powder products like powder detergent , Rice , beans etc .

Our machine is full automatic; it's equipped with a PLC touch screen that centralizes operations and an electronic system, our machines offer you ease programming and flexibility to adapt to the most demanding products and packaging films. The machine contains also an automatic fault detector, if any mistake or fault, the machine will stop automatically and the error will appear on the screen.

Our packaging machines allow you to make various types of packaging you just need to change the formers corresponding to the desired shape. And change the option on the touch screen.

The machine contains also a counting system that allow you to get the number of packed bags per day,

Also it has pneumatic printer for dates and photocell unit for printed folio

ADRESS: KIŞLA CAD. TOPÇULAR OTO SAN. SİTESİ NO:114 TOPÇULAR/İSTANBUL/TÜRKİYE

Tel: 0212 501 47 70 www.seyhanambalaj.com     [/seyhanambalajmakina](https://www.linkedin.com/company/seyhanambalajmakina)

TECHNICAL SPECIFICATIONS

Dosing system	4 heads weigher		
Products type	DETERGENT		
Dimension of the machine	Length	Width	Height
	6000 mm	1500 mm	4000 mm
Bag Weight	1 KG – 5 KG		
Accuracy	+/- 1-2 gr		
Production capacity	FOR 5 KG – 20- 35 bag /min The number of packages may vary depending on the package quality and product quality.		
Bags types	Pillow bag 		
Packaging Types	FOLIO ALUMINIUM, OPP+OPP, OPP+PE, METALISEE+PE,		
Dimension of bag	Width	Length	
	32 cm	45 cm	









Dimension of coil	Max 63 cm
Structure and body of the machine	All surfaces in contact with the products are stainless
PLC	XGB – XBC – DN64H - LS COREEN
Numerator	IG5A - LS COREEN
Electrical components	Schneider , WEIDMULLER - Germany
Transformer – regulator	SIEL ELECTRONIC
Motor	BONFIGLIOLI
Redictor – gear	BONFIGLIOLI
Pneumatic Cylinder	SMC
Alimentation – electricity	380 V Triphase - 220 V stable
Power consumption	12 KW - 50 Hz
Air consumption	6 Bar , 500 L / min

ADRESS: KIŞLA CAD. TOPÇULAR OTO SAN. SİTESİ NO:114 TOPÇULAR/İSTANBUL/TÜRKİYE

Tel: 0212 501 47 70 www.seyhanambalaj.com     [/seyhanambalajmakina](https://www.linkedin.com/company/seyhanambalajmakina)

Accessories

1	GOLD – PACKING MACHINE	1	
2	4 HEADS WEIGHER	1	
3	FORMERS	1	

4	PAINTED PLATFORM	1	
5	OUTPUT CONVEYOR 2m	1	
6	PNEUMATIC PRINTER	1	
7	Extra accessories	1	Hot jaw set

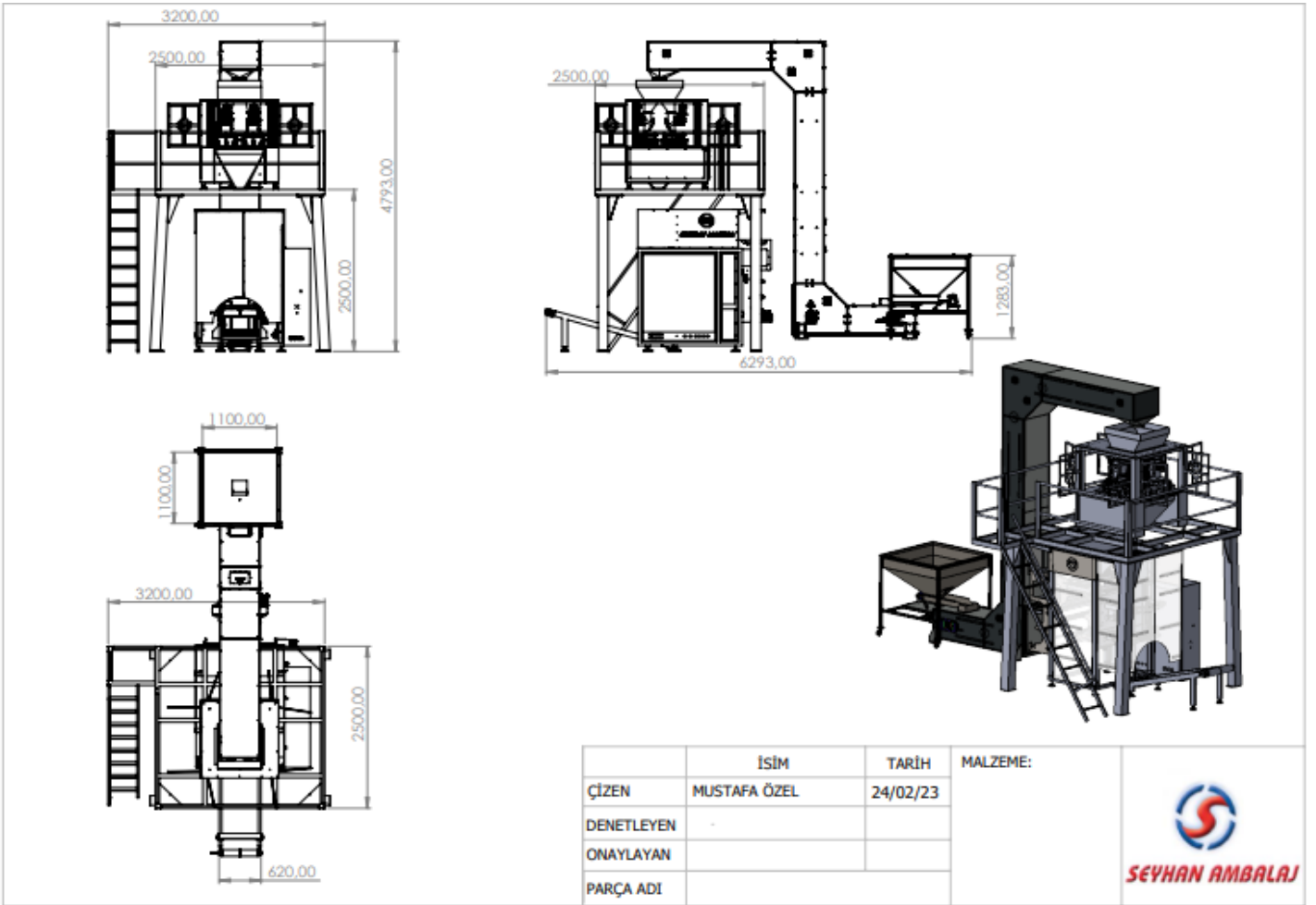

ADRESS: KIŞLA CAD. TOPÇULAR OTO SAN. SİTESİ NO:114 TOPÇULAR/İSTANBUL/TÜRKİYE

Tel: 0212 501 47 70 www.seyhanambalaj.com     [/seyhanambalajmakina](https://www.linkedin.com/company/seyhanambalajmakina)



DELIVERY TIME AND CONDITIONS

Our machines are delivered between 6 / 8 weeks depending on the production situation. The exact delivery time is determined after the contract is signed and the prepayment is received.

- **Delivery place : NEVSEHIR * EXW ***
- **The BUYER is obliged to cover the flight ticket costs, local costs and transportation cost of our technical team of two.**

WARRANTY & TECHNICAL SERVICE

The machine is guaranteed for 2 (TWO) YEARS against manufacturing and assembly faults, excluding wearing parts. All electrical, electronic and pneumatic materials on the machine are under the guarantee of the companies that produce these materials. During the warranty period, the round-trip transportation costs of the service personnel to be requested for the service covered by the warranty belong to the buyer company. Damages and wearing parts caused by operating errors, electrical fluctuations, grounding faults are excluded from the warranty. Seyhan Ambalaj Makina is not responsible for any malfunctions and problems that may occur in the machine in case of providing outside service to the machine other than Seyhan Ambalaj Makina's authorized service and purchasing spare parts from a company other than Seyhan Ambalaj Makina.

ADRESS: KIŞLA CAD. TOPÇULAR OTO SAN. SİTESİ NO:114 TOPÇULAR/İSTANBUL/TÜRKİYE

Tel: 0212 501 47 70 www.seyhanambalaj.com     [/seyhanambalajmakina](https://www.linkedin.com/company/seyhanambalajmakina)