

RD 10 | METERING VALVE

- Needle valve for various pure gases.
- This metering valve has a very precise flow setting and is ideally suited for use on regulators outlet.

NEEDLE VALVE

- ★ Low-pressure
- ★ With needle
- ★ Multi-turn

Special requirements on request

KEY FEATURES

- Purity up to 6.0
- Multi-turn version
- Straight or right angle versions
- Chrome plated brass or stainless steel
- Small size
- Low torque operation
- Very precise setting
- Delivered with light grey handwheel
- Not to be used as a shut off valve

OPTIONS

- Many inlet/outlet fittings available
- NBR or FPM O-ring
- For acetylene use, this valve must imperatively be installed with a flash back arrestor complying with standard EN 730 located downstream

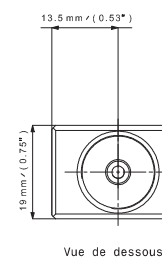
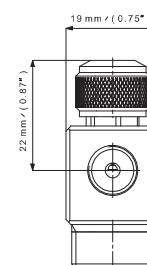
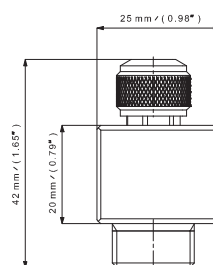
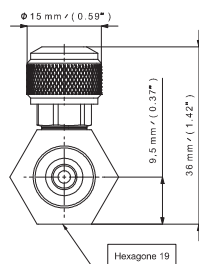
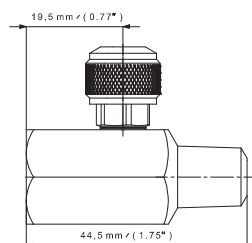

SPECIFICATIONS

Ports	Male inlet: G 3/8 or 1/4 NPT Female outlet: G 1/8 or 1/4 NPT	Max of turns open for max flow	3 turns	Inlet pressure	60 bar 870 psi
Seat seal	Metal / metal	Weight	± 0,085 kg ± 0.19 lbs	Flow coefficient	Cv 0.116. Kv 0,10 (straight) Cv 0.174. Kv 0,15 (90°)
O-ring	EPDM - Standard NBR FPM	Temperature range	-20°C to +50°C -4°F to +122°F	Oxygen use	OK with P1=30 bar max
Bottom tapered	No	Seat orifice size	Ø 2,5 mm		

PRODUCT CONFIGURATOR

RD	Body Material		10	End Connections		Version		O-ring Material
	L	L		G	G	D	D	EPDM
	Chrome plated brass	L		In: G 3/8 - Male Out: G 1/8 - Female	G	Straight	D	EPDM - standard
	Stainless steel	I		In: 1/4 NPT - Male Out: 1/4 NPT - Female	N	Right angle	E	NBR
				In: G 3/8 - Male Out: 1/4 NPT - Female	GN			FPM
				In: 1/4 NPT - Male Out: G 1/8 - Female	NG			