



VALVOLA DI SICUREZZA SAFETY VALVE

MOD. VEDI TABELLA
MOD. SEE LIST

Cod: **07VSXXX**
Code: **07VSXXX**

CARATTERISTICHE:
CHARACTERISTICS:

| CODICE A.L.B.A. A.L.B.A. CODE | MODELLO TYPE | IMPIEGO USAGE | MATERIALE/MATERIAL | |
|----------------------------------|----------------------|----------------------------|------------------------|--|
| | | | CORPO BODY | SPEGNI FIAMMA CUT OF FLAME |
| 07VS009 | SH/M 3/4" BSP | OSSIGENO OXYGEN | OT-58 OT-58 | BZ SINTERIZZATO SINTERED BZ |
| 07VS010 | SH/M 1/2" BSP | OSSIGENO OXYGEN | OT-58 OT-58 | BZ SINTERIZZATO SINTERED BZ |
| 07VS011 | SH/M 1/2" BSP | GAS GAS | OT-58 OT-58 | BZ SINTERIZZATO SINTERED BZ |
| 07VS012 | SH/M 3/8" BSP | OSSIGENO OXYGEN | OT-58 OT-58 | BZ SINTERIZZATO SINTERED BZ |
| 07VS013 | SH/M 3/8" BSP | GAS GAS | OT-58 OT-58 | BZ SINTERIZZATO SINTERED BZ |
| 07VS015 | SHG/F 1/2" BSP | ACETILENE ACETYLENE | OT-58 OT-58 | BZ SINTERIZZATO SINTERED BZ |
| 07VS018 | SHM/G 3/4" BSP | GAS GAS | OT-58 OT-58 | BZ SINTERIZZATO SINTERED BZ |
| 07VS019 | SH/M 3/4" BSP | GAS GAS | OT-58 OT-58 | BZ SINTERIZZATO SINTERED BZ |
| 07VS024 | SH/F 3/8" BSP | GAS GAS | OT-58 OT-58 | BZ SINTERIZZATO SINTERED BZ |
| 07VS025 | SH/F 1/2" BSP | OSSIGENO OXYGEN | OT-58 OT-58 | BZ SINTERIZZATO SINTERED BZ |
| 07VS026 | SH/F 1/2" BSP | GAS GAS | OT-58 OT-58 | BZ SINTERIZZATO SINTERED BZ |
| 07VS029 | SHF 1/2" BSP | GAS GAS | OT-58 OT-58 | BZ SINTERIZZATO SINTERED BZ |
| 07VS030 | SH/MF 1/2" BSP | OSSIGENO OXYGEN | OT-58 OT-58 | BZ SINTERIZZATO SINTERED BZ |
| 07VS031 | SH/MF 1/2" BSP | GAS GAS | OT-58 OT-58 | BZ SINTERIZZATO SINTERED BZ |
| 07VS032 | SH/MF 3/8" BSP | OSSIGENO OXYGEN | OT-58 OT-58 | BZ SINTERIZZATO SINTERED BZ |
| 07VS033 | SH/MF 3/8" BSP | GAS GAS | OT-58 OT-58 | BZ SINTERIZZATO SINTERED BZ |
| 07VS034 | SH/AF 3/8" BSP | ACETILENE ACETYLENE | OT-58 OT-58 | BZ SINTERIZZATO SINTERED BZ |
| 07VS035 | SH/AF 1/2" BSP | ACETILENE ACETYLENE | OT-58 OT-58 | BZ SINTERIZZATO SINTERED BZ |
| 07VS036 | SH/AF 1/2" BSP | ACETILENE ACETYLENE | OT-58 OT-58 | BZ SINTERIZZATO SINTERED BZ |
| 07VS200 | SH/F 3/8" BSP | OSSIGENO OXYGEN | OT-58 OT-58 | BZ SINTERIZZATO SINTERED BZ |
| 07VS202 | SH/F 1/4" BSP | OSSIGENO OXYGEN | OT-58 OT-58 | BZ SINTERIZZATO SINTERED BZ |
| 07VS205 | SHO/F 1/4" BSP | OSSIGENO OXYGEN | OT-58 OT-58 | BZ SINTERIZZATO SINTERED BZ |

ردیف ۲ در جدول ۱۰/۱۴۴۵





| CODICE A.L.B.A. A.L.B.A. CODE | MODELLO TYPE | IMPIEGO USAGE | MATERIALE/MATERIAL | |
|----------------------------------|-----------------|------------------------|--------------------|--------------------------------|
| | | | CORPO BODY | SPEGNI FIAMMA CUT OF FLAME |
| 07VS212 | SH/F 3/4" BSP | GAS GAS | OT-58 OT-58 | BZ SINTERIZZATO SINTERED BZ |
| 07VS213 | SHA/F 3/4" BSP | ACETILENE ACETYLENE | OT-58 OT-58 | BZ SINTERIZZATO SINTERED BZ |
| 07VS214 | SHG/F 3/4" BSP | GAS GAS | OT-58 OT-58 | BZ SINTERIZZATO SINTERED BZ |
| 07VS215 | SHG/F 3/4" BSP | GAS GAS | OT-58 OT-58 | BZ SINTERIZZATO SINTERED BZ |
| 07VS220 | SH/F 3/4" BSP | GAS GAS | OT-58 OT-58 | BZ SINTERIZZATO SINTERED BZ |



| CODICE A.L.B.A. A.L.B.A. CODE | DIMENSIONI(mm)/DIMENSION(mm) | | | | | |
|--|------------------------------|------------|----|-----|-------|-------------------|
| | D | DI | D2 | L | DWG. | PESO WEIHT(Kg) |
| 07VS009 | 3/4" | 3/4" | 34 | 155 | SH/M | 0.7 |
| 07VS010 | 1/2" | 1/2" | 34 | 152 | SH/M | 0.6 |
| 07VS011 | 1/2" sx-lh | 1/2" sx-lh | 34 | 152 | SH/M | 0.6 |
| 07VS012 | 3/8" | 3/8" | 34 | 150 | SH/M | 0.6 |
| 07VS013 | 3/8" sx-lh | 3/8" sx-lh | 34 | 150 | SH/M | 0.6 |
| 07VS015 | 1/2" sx-lh | 1/2" sx-lh | 34 | 152 | - | 0.6 |
| 07VS018 | 3/4" sx-lh | 3/4" sx-lh | 34 | 155 | - | 0.7 |
| 07VS019 | 3/4" | 3/4" | 34 | 155 | SH/M | 0.7 |
| 07VS024 | 3/8" sx-lh | 3/8" sx-lh | 34 | 147 | SH/F | 0.6 |
| 07VS025 | 1/2" | 1/2" | 34 | 152 | SH/F | 0.6 |
| 07VS026 | 1/2" | 1/2" | 34 | 152 | SH/F | 0.6 |
| 07VS029 | 1/2" sx-lh | 1/2" sx-lh | 34 | 152 | SH/F | 0.6 |
| 07VS030 | 1/2" | 1/2" | 38 | 173 | SH/MF | 0.7 |
| 07VS031 | 1/2" sx-lh | 1/2" sx-lh | 38 | 173 | SH/MF | 0.7 |
| 07VS032 | 3/8" | 3/8" | 38 | 168 | SH/MF | 0.7 |
| 07VS033 | 3/8" sx-lh | 3/8" sx-lh | 38 | 168 | SH/MF | 0.7 |
| 07VS034 | 3/8" sx-lh | 3/8" sx-lh | 34 | 147 | SH7AF | 0.6 |
| 07VS035 | 1/2" sx-lh | 1/2" sx-lh | 34 | 152 | SH7AF | 0.6 |
| 07VS036 | 1/2" | 1/2" | 34 | 156 | SH7AF | 0.6 |
| 07VS200 | 3/8" | 3/8" | 34 | 147 | SH/F | 0.6 |
| 07VS202 | 3/4" | 3/4" | 34 | 156 | SH/F | 0.7 |
| 07VS205 | 3/4" | 1/2" | 34 | 156 | - | 0.7 |
| 07VS212 | 3/4" | 3/4" | 34 | 156 | SH/F | 0.7 |
| 07VS213 | 3/4" | 3/4" | 34 | 156 | - | 0.7 |
| 07VS214 | 1/2" | 3/4" | 34 | 156 | - | 0.7 |
| 07VS215 | 3/4" | 1/2" | 34 | 156 | - | 0.7 |

ردیف درجوات 14548





| | | | | | | |
|---------|-----------|-----------|----|-----|------|-----|
| 07VS220 | 3/4"sx-lh | 3/4"sx-lh | 34 | 156 | SH/F | 0.7 |
|---------|-----------|-----------|----|-----|------|-----|

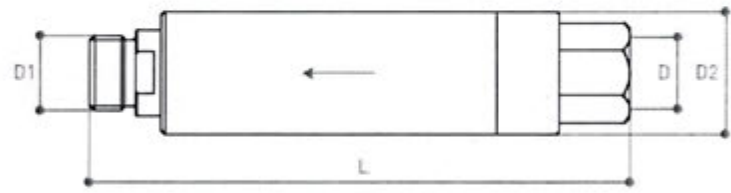

SH/AF

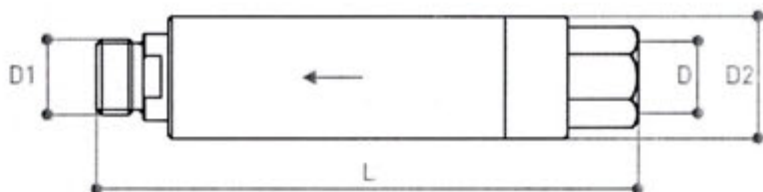

SH/F

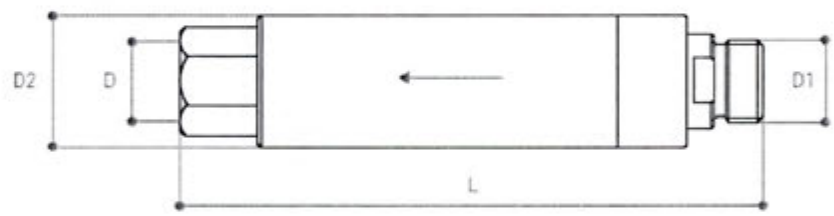

SH/M

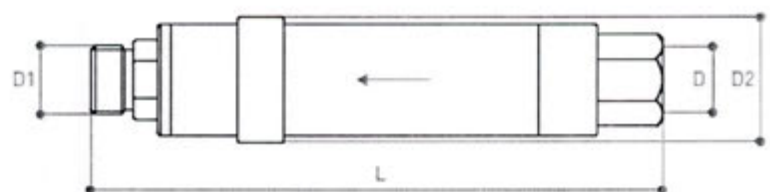

SH/MF

ردیف ۶ درخواست ۱۵/۲۹۵

