

WAFER SWING CHECK VALVE – DN32 (1"1/4) to DN600 (20")

PVC-U/PVC-C/PP-H

Conform to the 2014/68/EU Directive



DN50 –PVC-U

MAIN FEATURES

- Solid check valve for an optimal mechanical resistance.
- Wafer mounting between flanges for a reduced bulk.
- Internal seals in EPDM or FPM on request.
- Given its operating principle, the non-spring version of this valve must be mounted vertically, the fluid flowing from bottom to top in the flow direction.
- The spring version of this valve can be mounted horizontally, but only the vertical mounting guarantees tightness in the non-flowing direction

Les descriptions et caractéristiques figurant sur ce document sont données uniquement à titre d'information et non d'engagement contractuel. SAFI se réserve le droit d'effectuer sans préavis, toute modification.
SAFI has a policy of continuously developing its product range and the above data is subject to change without prior notification.

Die Beschreibungen und Daten, die sich auf diesem Dokument befinden, sind rein informativ und unverbindlich. SAFI behält sich vor, ohne Vorankündigung Änderungen vorzunehmen, die als technisch notwendig erachtet werden.
Las descripciones y características que figuran en este documento son indicativas. En ningún caso son contractuales. SAFI se reserva el derecho sin previo aviso de efectuar cualquier modificación.

SAFI

Av. Jacques Moison – BP 1
26770 TAULIGNAN
FRANCE
Tél.: (+33) 04 75 53 56 29
Fax : (+33) 04 75 53 62 78
info@safi-valves.com

SAFI Limited

35 Holton Road
Holton Heath Trading Park
POOLE Dorset - BH16 6LT
UNITED KINGDOM
Tél.: (+44) 1202 624618
Fax : (+44) 1202 628500
sales@safi-valves.com

SAFI Deutschland

Kunststoffarmaturen
Vertriebs GmbH
Jahnstrasse 29
64319 PFUNGSTADT
DEUTSCHLAND
Tél. : (+49) 61 57 81 919
Fax : (+49) 61 57 82 025
info-deutschland@safi-valves.com

SAFI Fábrica de Válvulas

C/ Carboners, 35
Pol. Ind. La Cometa
43700 EL VENDRELL
TARRAGONA-ESPAÑA
Tel.: (+34) 977 665 147
Fax : (+34) 977 664 989
info@safi-valvulas.com

SAFI América

Las Garzas Trade Center
Las Garzas #950
Quilicura
SANTIAGO – CHILE
Tél.: (+56 2) 2 510 3500
info@safi-america.com

SAFI América Perú S.A.C

José Gabriel Aguilar 240
San Miguel
LIMA - PERÚ
Tél.: (+51) 1 773 2802
peru@safi-america.com

DIMENSIONS

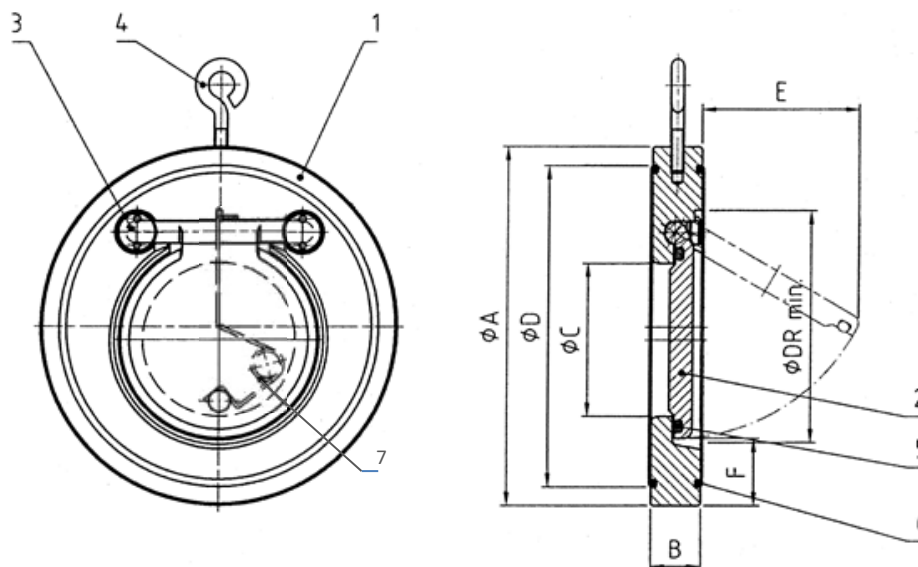

Diagram representing a DN50

DN	A		B	C	D	E	F	DR	Weight (Kg)	Weight (Kg)
	DIN	ANSI							PVC-U	PP-H
32	85	74	15	18	59	22	25	37	0,14	0,09
40	95	83	16	22	72	25	28	43	0,17	0,10
50	109	105	18	32	86	37	29	54	0,28	0,17
65	129	124	20	40	109	50	31	70	0,34	0,22
80	144	137	20	54	119	61	32	82	0,45	0,27
100	164	175	23	70	146	77	31	106	0,62	0,39
125	195	197	23	92	173	94	35	131	0,8	0,52
150	220	222	26	105	197	100	40	159	1,2	0,745
200	275	279	34	154	255	152	38	207	2,2	1,5
250	330	340	40	192	312	180	41	260	3,6	2,4
300	380	410	45	227	363	215	41	309	5,2	3,4
350	440	451	49	266	416	245	54	341	8	5,3
400	491	514	65	310	467	285	55	392	13	8,5
450	541	549	68	350	520	330	61	442	16,8	12,5
500	596	606	78	400	550	385	58	493	22,6	15
600	698	718	97	486	659	470	60	595	39	26

DIN = the outside diameter of the valve ϕA , Allows mounting between flanges with drilling in accordance with EN 1092-1 PN10

ANSI = the outside diameter of the valve ϕA , Allows mounting between flanges with drilling in accordance with ASME B16.5 CLASS 150

PARTS LIST

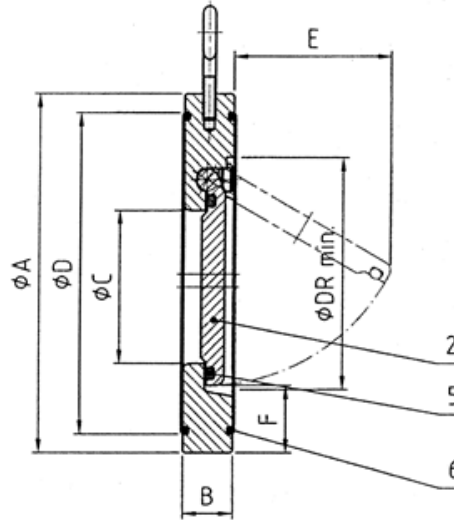
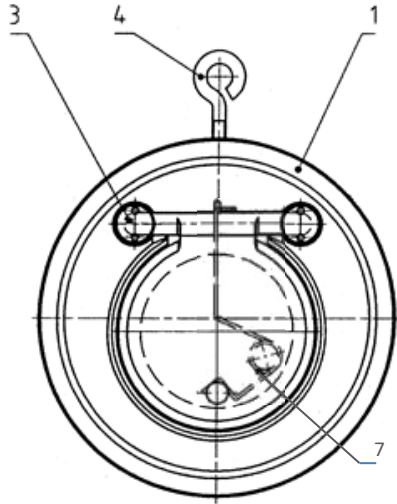

N°	QTY	DESCRIPTION	MATERIAL
1	1	BODY	PVC-U/PVC-C/PP-H
2	1	DISC	PVC-U/PVC-C/PP-H
3	2	SCREW	PVC-U/PVC-C/PP-H
4	1	HOOK	GALVANIZED STEEL
5	1	O-RING	EPDM / FPM
6	2	O-RING	EPDM / FPM
7	1	SPRING	SS 316

Note:

- It is recommended to never mount this type of check valve within one meter of a pump outlet (to avoid vibration and premature wearing).

PRESSURE / TEMPERATURE CURVES

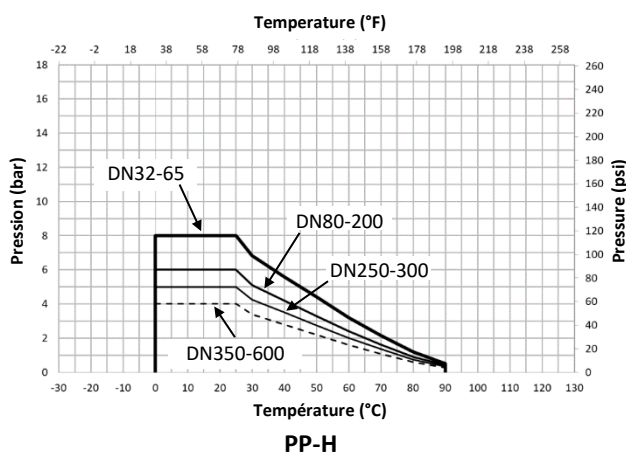
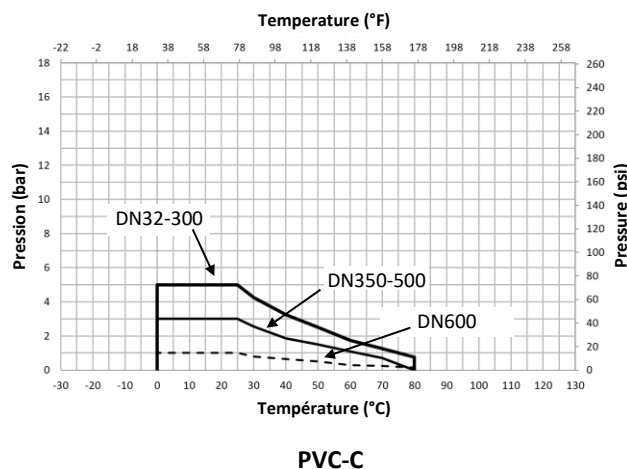
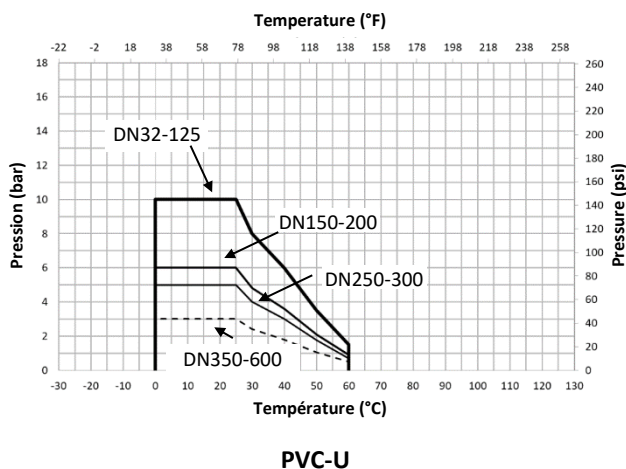

Pressure/Temperature Summary

Type of Seals	Working Pressure			Working Temperature		
	PVC-U	PVC-C	PP-H	PVC-U	PVC-C	PP-H
DN32 to DN65	10 bars	5 bars	8 bars	0°C To +60°C	0°C To +80°C	0°C To +90°C
DN80 to DN125	10 bars	5 bars	6 bars			
DN150 to DN200	6 bars	5 bars	6 bars			
DN250 to DN300	5 bars	5 bars	5 bars			
DN350 to DN500	3 bars	3 bars	4 bars			
DN600	3 bars	1 bars	4 bars			

The mechanical characteristics of the FPM and FFPM seals subjected to an ambient temperature below -5°C require the implementation of proper insulation on the valves equipped with such seals. Contact us for more information.

Les descriptions et caractéristiques figurant sur ce document sont données uniquement à titre d'information et non d'engagement contractuel. SAFI se réserve le droit d'effectuer sans préavis, toute modification.
SAFI has a policy of continuously developing its product range and the above data is subject to change without prior notification.

Die Beschreibungen und Daten, die sich auf diesem Dokument befinden, sind rein informativ und unverbindlich. SAFI behält sich vor, ohne Vorankündigung Änderungen vorzunehmen, die als technisch notwendig erachtet werden.
Las descripciones y características que figuran en este documento son indicativas. En ningún caso son contractuales. SAFI se reserva el derecho sin previo aviso de efectuar cualquier modificación.

PRESSURE LOSS

DN	Kv (m ³ /h)
32	16,2
40	22,2
50	54
65	75
80	112
100	172
125	342
150	490

DN	Kv (m ³ /h)
200	1128
250	1500
300	1914
350	2800
400	3700
450	4500
500	6450
600	6800

Kv defined according to NF EN 1267

Our valves are guaranteed for an average fluid velocity in the pipeline of ≤ 2 m/s. Please contact us with the working conditions for any higher speed.

CHEMICAL RESISTANCE

The chemical resistance of the valve is subject to the type of fluid, the temperature, the pressure, as well as the materials and seals of the valve.

Please contact us to have a personalized analysis of the resistance of one of our products to a given fluid

You can also consult, for information only, the table given in ISO 10358. However, this table cannot be considered as a recommendation by SAFI who could not be held liable for the use of this document.

DETERMINING A PRODUCT CODE

TYPE	SPECIFICATION	SPRING MATERIAL	DN		SEALS
4094 = PVC-U Swing Check Valve 4096 = PVC-C Swing Check Valve 4097 = PP-H Swing Check Valve	D = \emptyset outside diameter of the valve, Allows mounting between flanges with drilling in accordance with EN 1092-1 PN10 (DIN) A = \emptyset outside diameter of the valve, Allows mounting between flanges with drilling in accordance with ASME B16.5 CLASS 150 (ANSI)	R = Spring in Stainless Steel 316	03 = DN32 04 = DN40 05 = DN50 06 = DN65 07 = DN80 08 = DN100 09 = DN125 10 = DN150	11 = DN200 12 = DN250 13 = DN300 14 = DN350 15 = DN400 16 = DN450 17 = DN500 18 = DN600	EP = EPDM VT = FPM

Example: 4094D05EP

4094	D		05	EP
PVC-U Wafer Swing Check Valve	\emptyset outside diameter of the valve, Allows mounting between flanges with drilling in accordance with EN 1092-1 PN10 (DIN)		DN50	EPDM

Example: 4094AR10VT

4094	A	R	10	VT
PVC-U Wafer Swing Check Valve	\emptyset outside diameter of the valve, Allows mounting between flanges with drilling in accordance with ASME B16.5 CLASS 150 (ANSI)	Spring in Stainless Steel 316	DN100	FPM