

MEDIUM NAME: Dry Chlorine Gas Chlorine Liquefied Freon Gas Freon Liquid Waste Chlorine Gas.

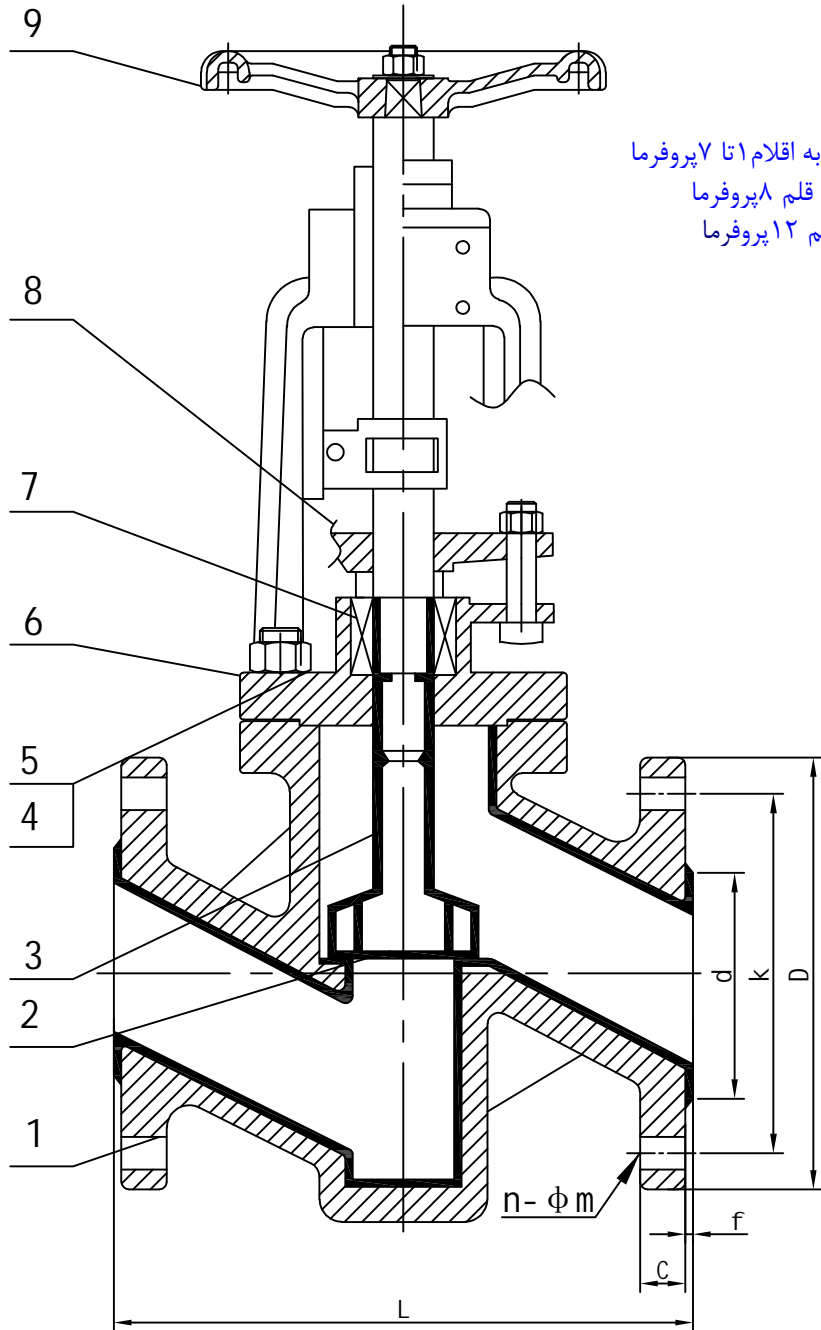

صفحه ۱ تا ۳ مربوط به اقلام اتا ۷ پروفرما
صفحه ۴-۶ مربوط به قلم ۸ پروفرما
صفحه ۷ مربوط به قلم ۱۲ پروفرما

NPS	L	D	K	n-φm	f	C	d
1/2"	130	95	65	4-φ14	2	16	45
1"	160	115	85	4-φ14	2	18	68
1-1/2"	200	150	110	4-φ18	3	18	88
2"	230	165	125	4-φ18	3	20	102
2-1/2"	290	185	145	8-φ18	3	22	122
3"	310	200	160	8-φ18	3	24	138
4"	350	235	190	8-φ22	3	24	162

Technical Requirements

- 1、Design & manufacture conform to GB/T 12235-2007.
- 2、Face to face dimension to GB/T 12221.
- 3、Flange Dimension to GB/T 9113.
- 4、Inspection and test JB/T 9092.

MAIN DIMENSIONS(UNIT:MM)

NO.	PART NAME	MATERIAL	NO.	PART NAME	MATERIAL
9	Hand wheel	WCB			
8	Gland	LCB			
7	Packing	PTFE			
6	Bonnet	LCB			
5	Nut	45			
4	Bolt	42CrMo			
3	Stem	LCB			
2	Disc	Coft osion resistart alloy			
1	Body	LCB			

PERFORMANCE SPECIFICATION

PN		25	
TEST PRESSURE	SHELL TEST	3.75	MPa
	SEAL TEST	2.75	
	AIR TEST	0.6	
SUTIABLE TEMPERATURE		≤150°C	

GONGNAI VALVE

GLOBE VALVE

TYPE: J41F-25 RF NPS 1/2"-4"

MEDIUM NAME: Dry Chlorine Gas Waste Chlorine Gas.

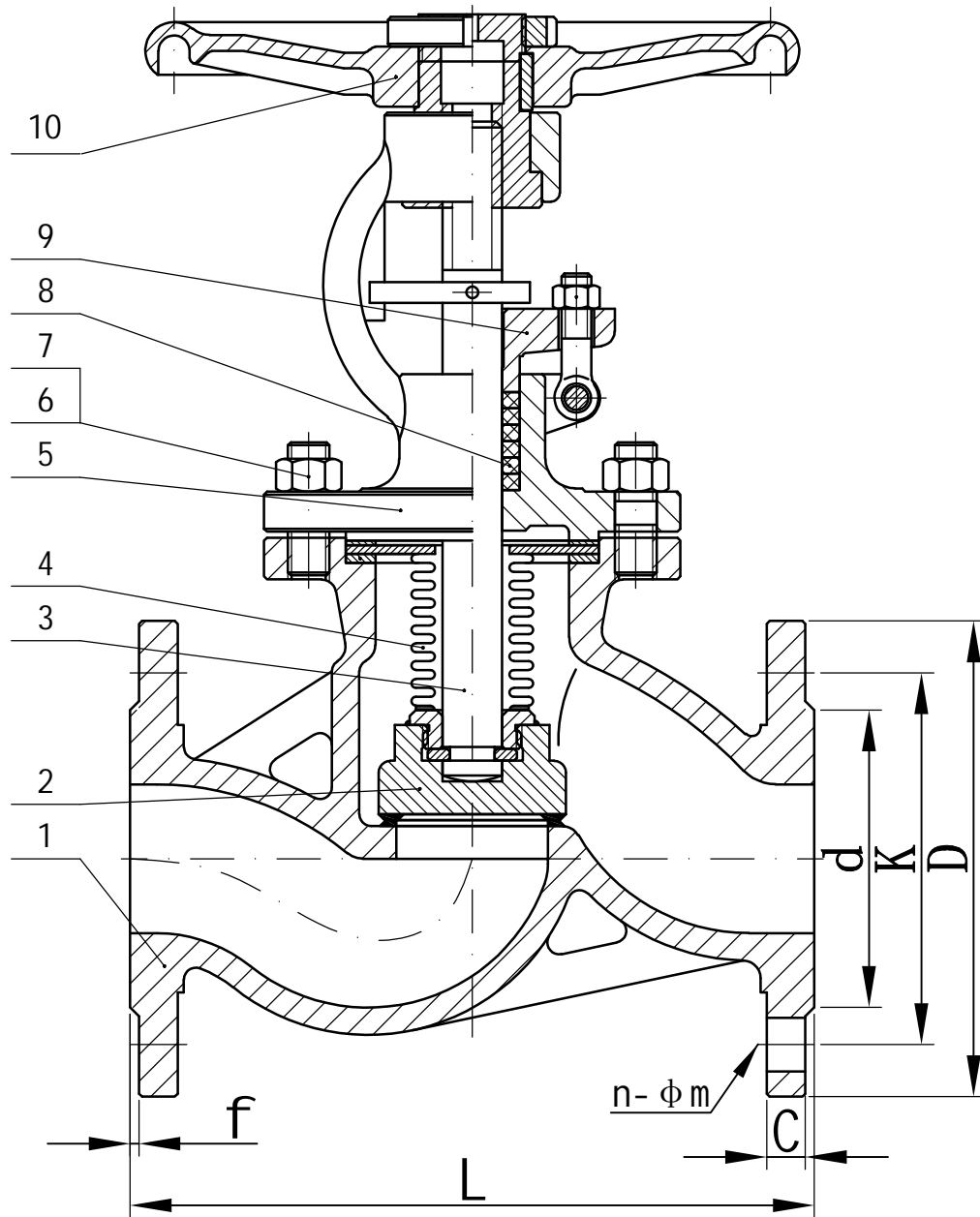

NPS	L	D	K	n-φm	f	C	d
1/2"	130	95	65	4-φ14	2	16	45
1"	160	115	85	4-φ14	2	18	68
1-1/2"	200	150	110	4-φ18	3	18	88
2"	230	165	125	4-φ18	3	20	102
2-1/2"	290	185	145	8-φ18	3	22	122
3"	310	200	160	8-φ18	3	24	138
4"	350	235	190	8-φ22	3	24	162

Technical Requirements

1. Design & manufacture conform to GB/T 12235-2007.
2. Face to face dimension to GB/T 12221.
3. Flange Dimension to GB/T 9113.
4. Inspection and test GB/T 13927.

MAIN DIMENSIONS (UNIT: MM)

10	Hand wheel	WCB			
9	Gland	LCB			
8	Packing	STL			
7	Nut	45			
6	Bolt	42CrMo			
5	Bonnet	LCB			
4	Bellows	STL			
3	Stem	LCB			
2	Disc	STL			
1	Body	LCB			

NO.	PART NAME	MATERIAL	NO.	PART NAME	MATERIAL
-----	-----------	----------	-----	-----------	----------

PERFORMANCE SPECIFICATION

PN		25	
TEST PRESSURE	SHELL TEST	3.75	MPa
	SEAL TEST	2.75	
	AIR TEST	0.6	
SUITABLE TEMPERATURE		≤300°C	

GONGNAI VALVE

Bellow Sealed Globe Valve

TYPE: WJ41Y-25C1 RF NPS 1/2"-4"

NPS	L	D	K	n- ϕm	f	C	d
2-1/2"	250	185	145	8- $\phi 18$	3	18	122

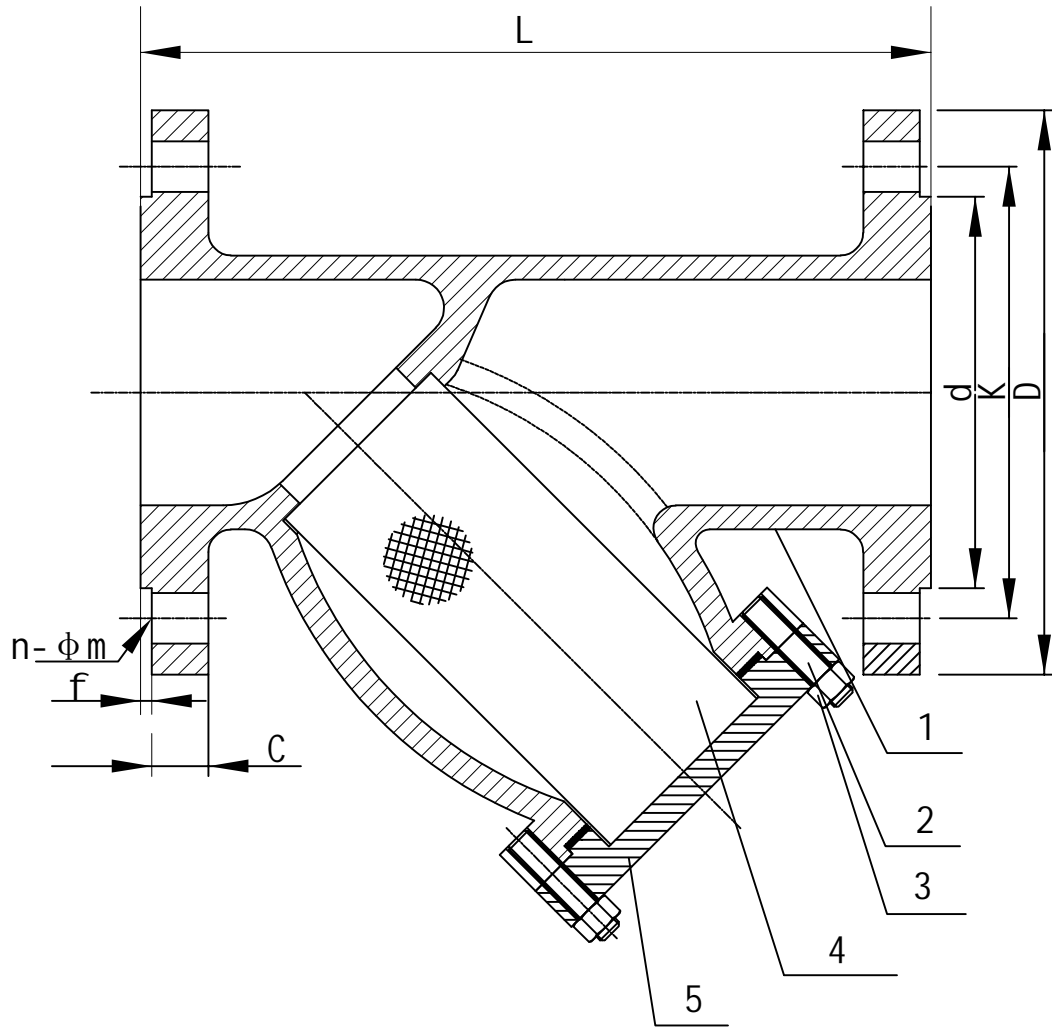

Technical Requirements

- Design & manufacture conform to HG/T 21637.
- Face to face dimension to GB/T 12221.
- Flange Dimension to GB/T 9113.
- Inspection and test GB/T 13927.

MAIN DIMENSIONS (UNIT: MM)

NO.	PART NAME	MATERIAL	NO.	PART NAME	MATERIAL
5	Bonnet	WCB+subzero treatment			
4	Mesh	304(500micron)			
3	Nut	45			
2	Bolt	42CrMo			
1	Body	WCB+subzero treatment			

PERFORMANCE SPECIFICATION		GONGNAI VALVE			
PN	16	Y Type Strainer			
TEST PRESSURE	SHELL TEST			2.40	MPa
	SEAL TEST			1.76	
	AIR TEST	0.6			
SUITABLE TEMPERATURE	≤150°C		TYPE: Y41-16 RF NPS 2-1/2"		

Nominal pressure MPa	2.5
Strength test	3.8
Seal test	3.8 MPa
Jacket test	1.0
Applicable temp	540 ° C
Applicable medium	Water, Steam, oil.

公称压力MPa	2.5		
强度试验	3.8	MPa	
密封试验	2.8		
夹套试验	1.0		
适用温度	<540 ° c		
适用介质	水, 蒸汽, 油品		

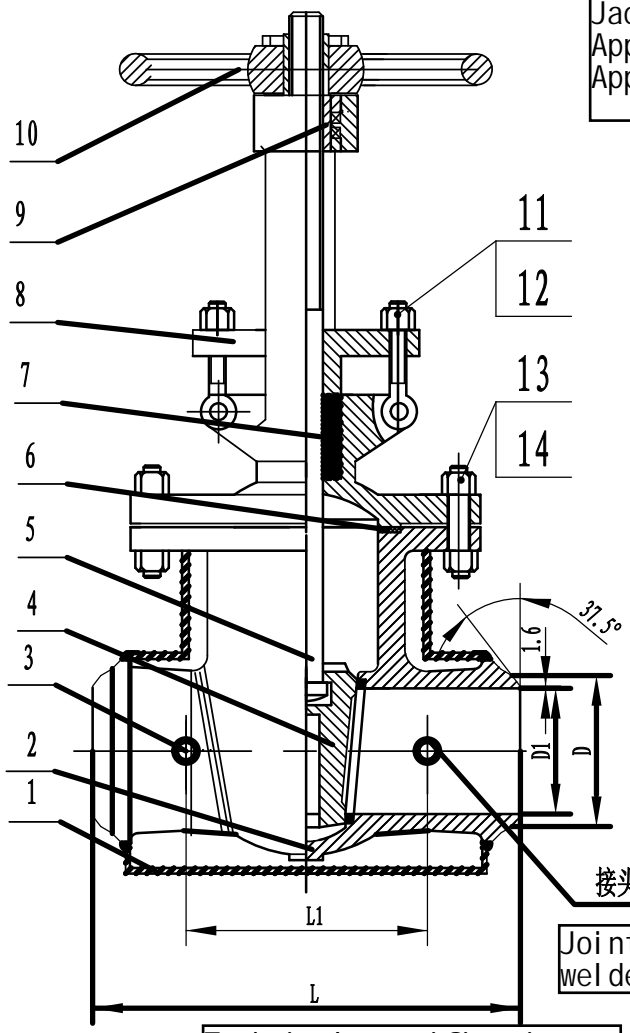

备注: 1、DN150阀门接管尺寸φ159×5;
2、N200阀门接管尺寸φ219×6;

Remark : 1. DN150 Valve nozzle size	159x5
2. DN200 Valve nozzle size	219x6

DN	L	D	D1	L1
150	350	162	150	250
200	400	223	203	300

No	Item	Material
14	Nut	35CrMo
13	Bol t	35CrMo
12	Eye let bol t	35CrMo
11	Nut	35CrMo
10	Handl e	35CrMo
9	Valve rod nut	ZQAL9-4
8	Packing presssure plate	WCB
7	Packin g	Expanded graphi te
6	Seal gasket	Expanded graphi te +304
5	Valve rod	F22
4	Valve plate	WC9+STL
3	Threaded joint	304
2	Valve body	WC9
1	Jacket	304

14	螺母	35CrMo
13	螺栓	35CrMo
12	活节螺栓	35CrMo
11	螺母	35CrMo
10	手柄	QT400
9	阀杆螺母	ZQAL9-4
8	填料压板	WCB
7	填料	柔性石墨
6	密封垫片	柔性石墨+304
5	阀杆	F22
4	闸板	WC9+STL
3	丝扣接头	304
2	阀体	WC9
1	夹套	304
序号	名称	材料

- 1. Technical standards for design and manufacturing refer to 《GB/T12234》
- 2. Standards for inspection and test refer to 《GB/T26480》
- 3. Size of welding end refer to 《NB/T47044-2014》

技术规范

- 1. 设计和制造按GB/T12234规定,
- 2. 检验与试验按GB/T26480标准规定,
- 3. 焊接端尺寸参考NB/T47044-2014.

设计	日期	2009.9.3
审核	日期	
标记	更改文件号	签字

夹套闸阀
Gate valve
阀体WC9/夹套304

BZ61Y-25I-DN150-200		
图样标记	重量	比例
共 张	第 张	

To Pars Chemia Chlor:

Date: September 6th, 2022

Commercial Quotation

S/N	Item Name	Description	Qty (Pcs)		
1	Gate Valve	Gate valve Size: 6 inch Connection type: welded connection Fluid: Molten Salt	1		
2	Valve plate	WCB	1		
3	Valve rod	F22	1		
4	Packing pressure plate	WC9+STL	1		
5	Seal plate	Graphite+304	1		

Remark:

1. Payment Terms: 30% advance payment by TT, 70% balance payment before shipment.
2. Time of delivery: 70 days after receiving advance payment.
3. Quotation Valid Date: 90 days.
4. The quotation including domestic transportation to designated port, and wood case package for export.

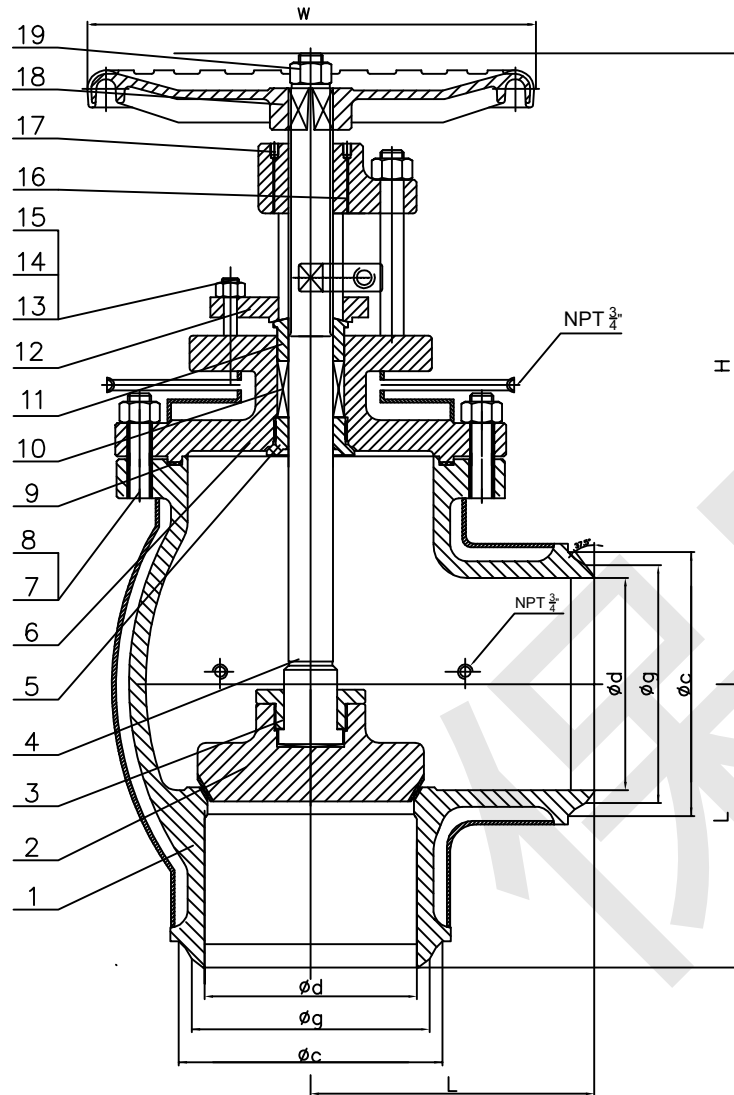

Performance specification sheet

Nominal pressure	CLASS	300
Test Strength test		7.5
Upper seal test		5.5
Seal test		5.5
Pressure Gas seal test		0.6
Maximum working temp		540 °C

Applicable medium : Water, Steam, oil, etc

性能规范表

公称压力		CLASS 300	
试验压力	强度试验	7.5	MPa
	上密封试验	5.5	
	密封试验	5.5	
	气密封试验	0.6	
最高工作温度		540 °C	
适用介质: 水, 蒸汽, 油品等			

技术要求

- 设计、制造技术要求按BS 1873 的规定。
- 阀门结构长度按ANSI B16.10 的规定。
- 焊接接口按 按用户要求
- 压力-温度基准按ANSI B16.34 的规定。

Technical requirement

- Technical standards for design and manufacturing 《BS 1873》
- Valve structure and length standards 《ANSI B16.10》
- The welding groove standard as the client requirement.
- Pressure-temperature standards 《ANSI B16.34》

No	Item	Material
1	阀体 Valve body	15Cr1MoV
2	阀瓣 Valve flap	15Cr1MoV
3	阀瓣盖 Valve flap cap	15Cr1MoV
4	阀杆 Valve rod	2Cr13
5	倒密封座 Seal seat	2Cr13
6	阀盖 Valve cap	15Cr1Mo1V
7	六角螺母 Hexagon nut	35CrMoV
8	双头螺栓 Double-headed stud	35CrMoV
9	缠绕垫 Spiral wound gasket	304+石墨 Graphite
10	填料 Packing	柔性石墨 Expanded graphite
11	压套 Pressure sleeve	F304
12	压盖 Pressure cap	15Cr1Mo1V
13	活字螺栓 Eyelet bolt	A193 B7
14	螺母 Nut	A194 2H
15	圆销 Round pin	25
16	阀杆螺母 Valve rod nut	ZQAL9-4
17	开槽锥端固定螺钉 slotted cone pointed screw	A3
18	手轮 Hand wheel	KTH330-08
19	螺母 Nut	A194 2H

4"	102	146	404	280			114.3*4.0	
6"	152	203	567	400			168.3*7.1	
8"	203	248	630	420			219.1*8.0	
NPS	d	L	H	W	g	c	接管尺寸	数量

Pipe connection size

设计	审核	标准化	日期
校对	审定		
审核	批准		
工艺	日期	22.05.12	

15Cr1Mo1V 铬钼钒钢		
Gate valve 高温焊接保温角阀—总装图		
图样标记	数量	重量
4~8" J64Y-300LbV-00		

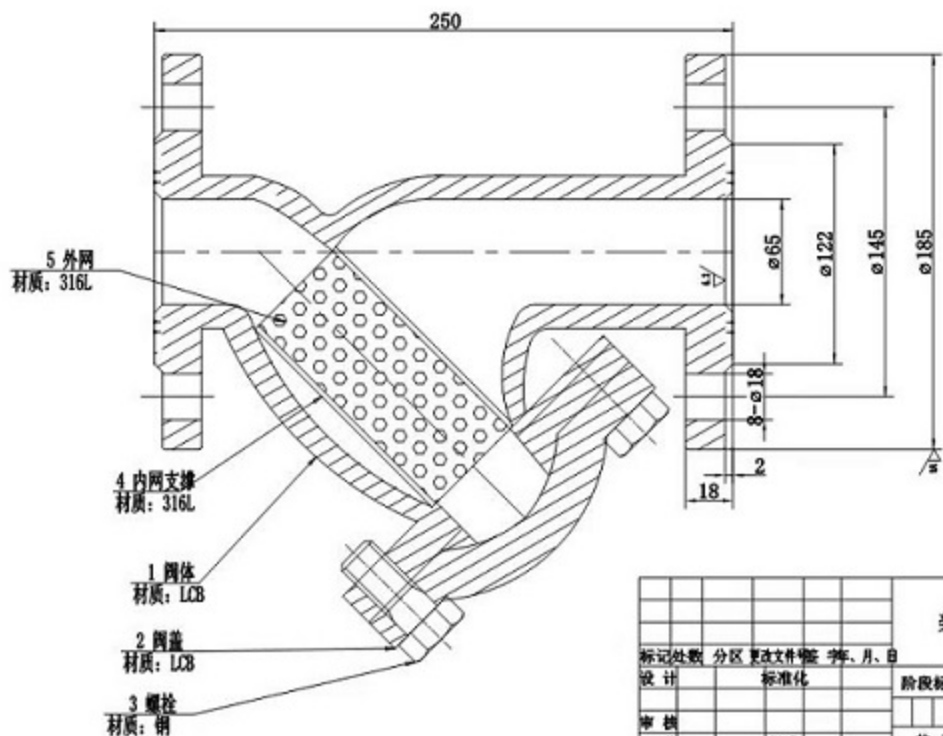

图号	
图名	
图例	
图号	
图号	
签字	
日期	

				装配图			河南中核氟氯阀门科技股份有限公司		
标记处数 分区 更改文件编号 签字、月、日							Y型过滤器		
设计				标准化			阶段标记 重量 比例		
审核							1:1.5		
工艺				批准			共 1 套 1 张		
							CLY41W-16C-DN65-00		