

QUOTATION

FOR FACIAL TISSUE BOX PACKING MACHINE

PARS CREPE CO.,
 Add: No.8, Sahel Dead End.
 Between Hoseiniye Ershad And Mirdamad, Shariati AVE,
 TEHRAN, IR. IRAN
 Postal code:1948913611
 TEL: 0098-21-22847771/22849944
 Email address:info@cheshmak.com

Date:28th-Nov-2022

Content of present proposal:Total 11 pages

Description	page
1. machines price and remark	2
2. Specifications about the machine	10
3. Customer list	11

ZHEJIANG ONEPAPER SMART EQUIPMENT CO.,LTD

ADD: NO.301 WANXIANG ROAD, WANQUAN INDUSTRY PARK, PINGYANG COUNTY, ZHEJIANG PROVINCE, CHINA
 TEL/ FAX: +86-577-58190989 EMAIL: Jessica@one-paper.com

NO.	Product name	Specification	Unit	Quantity	Unit Price (USD)	Final price (USD)	Delivery (Pickup)Date
1	HIGH SPEED AUTOMATIC BOX PACKING MACHINE (ROTARY TYPE)	OPH-120B With Hot glue Machine (USA Nordson)	1	1	78,000	78,000	30 DAYS FROM THE DATE OF RECEIPT OF 30% ADVANCE PAYMENT
2	AUTOMATIC BOXING AND SEALING MACHINE	OPH-100B With Hot glue Machine (USA Nordson)	1	2	60,000	120,000	
TOTAL AMOUNT						198,000	
TOTAL AMOUNT FOB NINGBO CHINA TO SAY ONE HUNDRED NINETY EIGHT THOUSAND US DOLLAR .							

Remarks:

- 1.Extra conveyor will to be updated after make sure about the cad drawing of factory .
- 2.Payment:T/T 30% as deposit to start the production, 70% balance need to paid before delivery
- 3.Guarantee period: the guarantee period will be valid for one year,If buyer needs seller send technicians to install the machine and do training in **customer factory**, buyer should help to apply for the Visa, seller takes charge of the fees before going abroad, and buyer pays the round-trip air tickets, accommodation, meals, translator fees,transportation fees and \$100/day/person as allowance.
- 4.Quotation validity: 30 days
- 5.Spare parts:one year
- 6.Customer need to send the finished tissue product size list as length ,width, height for box with stamped to make sure the machine specification .The size list as following below :

For example For box size :

	LENGTH	WIDTH	HEIGHT	SHEETS
1				
2				
3				

ZHEJIANG ONEPAPER SMART EQUIPMENT CO.,LTD

ADD: NO.301 WANXIANG ROAD, WANQUAN INDUSTRY PARK, PINGYANG COUNTY, ZHEJIANG PROVINCE, CHINA
TEL/ FAX: +86-577-58190989 EMAIL: Jessica@one-paper.com

SPECIFICATION

PICTURE1:
OPH-120B high-speed automatic facial tissue box-in and box-sealing machine (Rotary type)

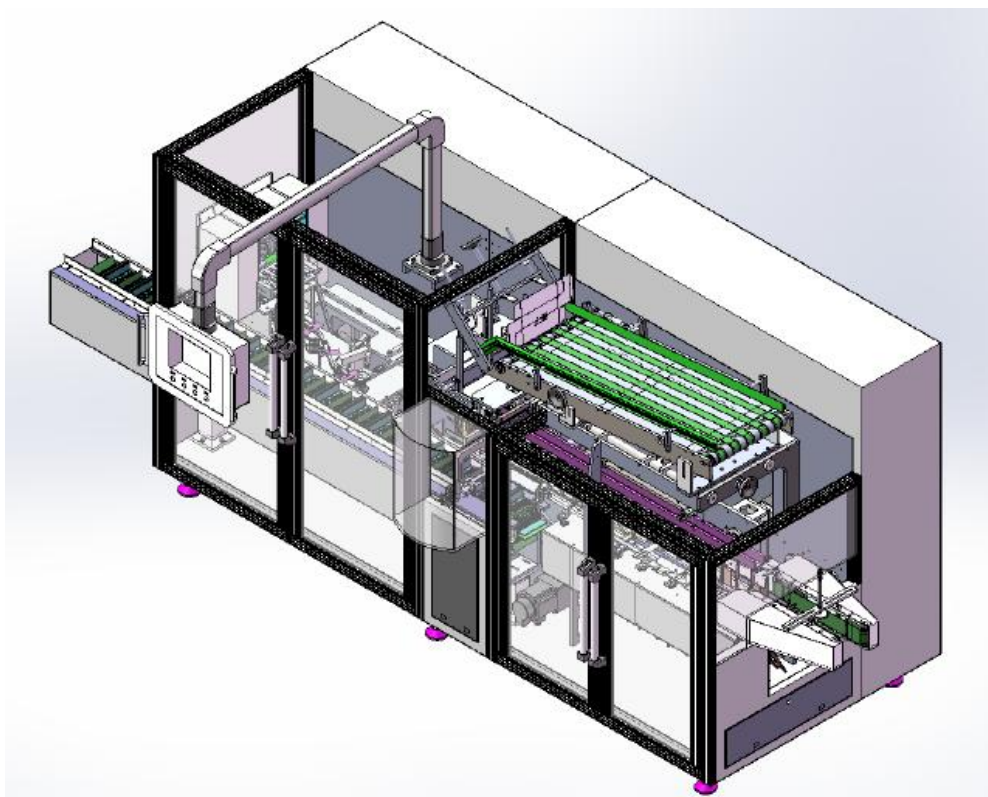

ZHEJIANG ONEPAPER SMART EQUIPMENT CO.,LTD

ADD: NO.301 WANXIANG ROAD, WANQUAN INDUSTRY PARK, PINGYANG COUNTY, ZHEJIANG PROVINCE, CHINA
TEL/ FAX: +86-577-58190989 EMAIL: Jessica@one-paper.com



Expert of Tissue Equipment



Excellent Chinese brand products, design speed 150 boxes/min

Four innovations of the machine

1. Rotary type box taking/opening/feeding, the operation is more stable;
2. Remote IoT, data management, smarter operation;
3. Voice prompts on human nature; human-computer interaction experience understands you better;
4. Four-axis servo linkage, simplifying mechanical design and making it more comfortable.

Application range:

Suitable for automatic box-sealing packaging of facial tissues, napkins, square tissues, handkerchiefs, cotton soft towels, etc.

Main performances and structure features:

1. Complete the steps of automatic feeding, box opening, boxing, batch numbering (optional), glue spraying, box sealing, etc., with compact and reasonable structure, simple operation and adjustment;
2. Using 4-axis servo motor and touch screen, PLC programmable control system, the man-machine interface display operation is clearer and simpler, with high automation and more humane;
3. It adopts automatic material sorting and conveying mechanism, which is convenient for linkage production with automatic production line, which can greatly reduce labor costs;
4. The photoelectric eye automatic detection and tracking system is adopted, and the box can not be placed in an empty package, which saves packaging materials to the greatest extent;
5. The packaging range is large, the adjustment is convenient, and the quick conversion between various specifications and sizes can be realized;
6. Changing specifications does not require a large number of mold changes, only adjustment or replacement of individual parts can be achieved;
7. It adopts automatic shutdown and main drive motor overload protection device if the item is not in

ZHEJIANG ONEPAPER SMART EQUIPMENT CO.,LTD

ADD: NO.301 WANXIANG ROAD, WANQUAN INDUSTRY PARK, PINGYANG COUNTY, ZHEJIANG PROVINCE, CHINA
TEL/ FAX: +86-577-58190989 EMAIL: Jessica@one-paper.com

place, which is safer and more reliable;

8. According to customer requirements, a flip-up safety protective cover can be used, which is easy to operate and beautiful in appearance.

Performance technical parameters:

Item/model		OPH-120B
Paper quality of carton		300-400g/m ³
Maximum packing specification		L100-230mm×W80-140mm×H40-110mm
Packing speed		≤120 (boxes/minute)
Hot melt machine power		2.32KW
Motor power		4.87KW
Total power		7.2KW
Power supply type		(3phase 4wire) 380V 50Hz
Machine noise		≤80dB
Air supply		0.5-0.8 Mpa
Air consumption		160-200L/min
Outline dimensions	Main machine	L4550×W1650×H1950mm
	Conveying mechanism	L4000×W660×H1200mm
Machine weight		2150Kg

Note: The company's products are updated quickly. If there is any change, please refer to the actual product without notice!

Configuration List

name	model	number	brand
servo driver	ASD-M-0721-F	1	delta
servo driver	ASD-A3-0721-M	1	delta
servo motor	ECMA-C20807RS	4	delta
touch screen	HMIGXV3512	1	schneider
frequency converter	ATV12H037M2	1	schneider
frequency converter	ATV310HU15N4A	1	schneider

ZHEJIANG ONEPAPER SMART EQUIPMENT CO.,LTD

ADD: NO.301 WANXIANG ROAD, WANQUAN INDUSTRY PARK, PINGYANG COUNTY, ZHEJIANG PROVINCE, CHINA
TEL/ FAX: +86-577-58190989 EMAIL: Jessica@one-paper.com

PLC	CP2E-N60DT-D	1	omron
battery	CP2W-BAT02	1	omron
switching power supply	DR-60-24	1	menan well
Terminal fastener	E/JUK	2	weidmueller
a.c. contactor	LC1N3210M5N	1	schneider
miniature circuit breaker	OSMC32N1C10	1	schneider
miniature circuit breaker	OSMC32N2C20	1	schneider
miniature circuit breaker	OSMC32N3C20	1	schneider
miniature circuit breaker	OSMC32N3C32	1	schneider
intermediate relay	RJ2S-CL-D24	4	IDEC
Intermediate relay base	SJ2S-05B	4	IDEC
Terminal baffle	ZAP/TW1	1	weidmueller
Terminal baffle	ZAP/TW5	1	weidmueller
amphenol connector	ZDU2.5	150	weidmueller
amphenol connector	ZDU6	4	weidmueller
amphenol connector	ZPE2.5	2	weidmueller
soleniod valve	SY5120-5GZD-01	5	S M C
ENCODER	DBS36E-S3EM01000	1	SICK
Digital display air pressure switch	DPSN1-10020	1	AirTAC
Terminal fastener	E/JUK	4	weidmueller
SENSOR	GTB6-N1212	11	SICK
HMI	HMIGXV3512	1	schneider
green button	ZB2-BA3C	1	schneider
red button	ZB2-BA4C	1	schneider
yellow button	ZB2-BA5C	1	schneider
Emergency stop button	ZB2-BS54C	1	schneider
Button base	ZB2-BZ101C	2	schneider
Button base	ZB2-BZ102C	2	schneider
amphenol connector	ZDU2.5	40	weidmueller
amphenol connector	ZPE2.5	2	weidmueller
C45 socket	multi-function socket 10-16A	1	CHNT
voltage phase sequence protector	JVRD-380N	1	GINRI

ZHEJIANG ONEPAPER SMART EQUIPMENT CO.,LTD

ADD: NO.301 WANXIANG ROAD, WANQUAN INDUSTRY PARK, PINGYANG COUNTY, ZHEJIANG PROVINCE, CHINA
 TEL/ FAX: +86-577-58190989 EMAIL: Jessica@one-paper.com

485 repeater	RS485E	1	YNUIC
combination switch	HZ12-16/04	1	CanSen
ship solid state relay	SFV-05B	9	INNOVIT
SI intelligent signal light	5i-i3	1	ONN
vacuum genertor	BM20-C	4	HAN TIAN
main motor	MTD57-Y1.5-4P-10.77-M1-180	1	EVERGEAR
proximity switch	TL-12N4B	2	TOKY

PICTURE2:Automatic Facial Tissue Boxing And Sealing Machine OPH-100B

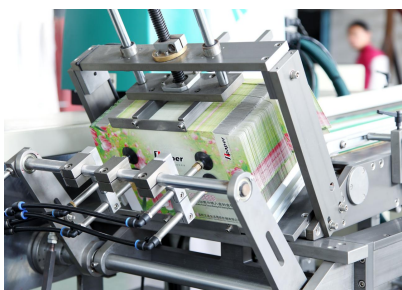

Five innovations of the machine

- 1、 High output. The stable speed can reach 80 boxes/minute.

ZHEJIANG ONEPAPER SMART EQUIPMENT CO.,LTD

ADD: NO.301 WANXIANG ROAD, WANQUAN INDUSTRY PARK, PINGYANG COUNTY, ZHEJIANG PROVINCE, CHINA

TEL/ FAX: +86-577-58190989 EMAIL: Jessica@one-paper.com



Expert of Tissue Equipment

2. Complete functions. The machine is suitable for various applications such as semi-cover/full-cover, or high paper and low box/low paper and high box.
3. Rapid production changing. It only takes 10-20 minutes to change the specifications.
4. Convenient operation. It is easy to control the servo paper feeding and PLC control system.
5. Low cost. The imported glue machine with a nozzle of 0.3mm is adopted and the glue-spread is little.

Application range:

It is suitable for automatic boxing of facial tissues, square tissues, pocket tissues, cotton tissues etc.

Main performances and structure features:

1. Packing forms such as automatic feeding, box opening, boxing, batch No. printing, glue spreading, box sealing, etc. are adopted. Featured by compact and reasonable structure, simple operation and adjustment.
2. Servo/step motor, touch screen, PLC control system and man-machine interface display make operation more clear and convenient. With high automation degree, the machine is more user-friendly.
3. The automatic material arranging and conveying mechanism is adopted to facilitate linked production with automatic production line, which can greatly reduce labor cost.
4. The photoelectric eye automatic detection tracking system is adopted. No boxing is made if the bag is empty, so as to save packing materials to the utmost extent.
5. With wide packing range and convenient adjustment, fast switching among various specifications and sizes can be realized.
6. Change of specifications does not need change of molds, but can be realized through adjustment.
7. Automatic stopping is available when the material boxing is not in place, and the main driving motor overload protection device is used, so that the machine is safer and more reliable.
8. According to customer requirements, the upturning type safety protective cover is adopted, which is featured by simple operation and beautiful appearance.

Performance technical parameters:

Item/model	OPH-100
Paper quality of carton	300-450g/m ³
Maximum packing specification	L240mm×W120mm×H100mm
Packing speed	30-100 (boxes/minute)
Hot melt machine power	2.50KW
Motor power	3.50KW

ZHEJIANG ONEPAPER SMART EQUIPMENT CO.,LTD

ADD: NO.301 WANXIANG ROAD, WANQUAN INDUSTRY PARK, PINGYANG COUNTY, ZHEJIANG PROVINCE, CHINA
TEL/ FAX: +86-577-58190989 EMAIL: Jessica@one-paper.com



Expert of Tissue Equipment

Total power		6.00KW
Power supply type		(3phase 4wire) 380V 50Hz
Machine noise		≤80dB
Air supply		0.5-0.8 Mpa
Air consumption		120-160L/min
Outline dimensions	Main machine	L3250×W1650×H1800mm
	Conveying mechanism	L4000×W660×H1200mm
Machine weight		1500 Kg

Configuration list

No.	name	Model/specification	Producing area/manuf actor	quantity	Note
1	Touch screen	NB7W-TWOOB	Omron	1	Color screen
2	PLC	CP1E-N60S1DT-D	Omron	1	
3	Frequency converter	ATV12H037M2	Schneider	1	
4		ATV310HU15N4A		1	
5	Encoder	E6B2-CWZ6C	Omron	1	
6	Servo motors	0.75KW	Delta	1	
7	Servo driver	ASD-A2-0721-M	Delta	1	
8		ASD-A2-0721-L	Delta	1	
9	photoelectricity	GTE6-N1211	SICK	13	
10	Proximity switch	TL-12N4B	TOKY	4	
12	Button	ZB2-BA3C	Schneider	3	
13	AC contactor	LC1-E3210	Schneider	1	
14	Intermediate relay	RJ2S-CL-D24	IDEC	13	
15	emergency stop	ZB2-BS54C	Schneider	1	

ZHEJIANG ONEPAPER SMART EQUIPMENT CO.,LTD

ADD: NO.301 WANXIANG ROAD, WANQUAN INDUSTRY PARK, PINGYANG COUNTY, ZHEJIANG PROVINCE, CHINA
 TEL/ FAX: +86-577-58190989 EMAIL: Jessica@one-paper.com



Expert of Tissue Equipment

	switch				
16	power supply	DR-60-24	Mean well	1	
17	Air switch	OSMC32N3C32	Schneider	1	
18	Air switch	OSMC32N3C20	Schneider	1	
19	Air switch	OSMC32N3C20	Schneider	1	
20	Air switch	OSMC32N3C10	Schneider	1	
21	Hot melt glue machine	MESA6	Nordson	1	two tubes two guns

Note: The products of our company may be always updated, and are subject to change without notice (the real products shall prevail).

Free parts

- 1. Proximity switch 1set;
- 2. photoelectricity 1set;
- 3. sucker 2 pcs;
- 4. aluminum pusher 1 set;
- 5. tool box 1 pc

ZHEJIANG ONEPAPER SMART EQUIPMENT CO.,LTD

ADD: NO.301 WANXIANG ROAD, WANQUAN INDUSTRY PARK, PINGYANG COUNTY, ZHEJIANG PROVINCE, CHINA
 TEL/ FAX: +86-577-58190989 EMAIL: Jessica@one-paper.com

We know what you need

Our customers



ZHEJIANG ONEPAPER SMART EQUIPMENT CO.,LTD

ADD: NO.301 WANXIANG ROAD, WANQUAN INDUSTRY PARK, PINGYANG COUNTY, ZHEJIANG PROVINCE, CHINA
 TEL/ FAX: +86-577-58190989 EMAIL: Jessica@one-paper.com